



Rist & Associates



HVAC Solutions

Complete suspension systems for a variety
of ductwork and HVAC services

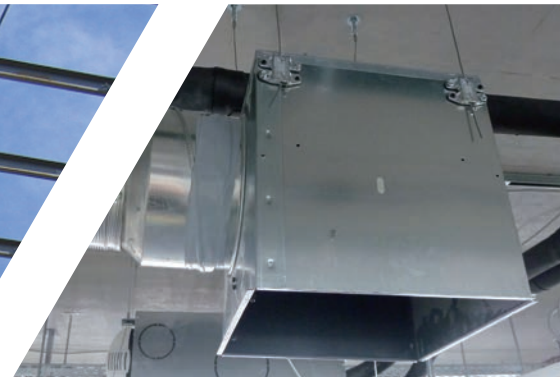

- Ready-to-use kits
- Easy and efficient installation
- Versatile suspension options

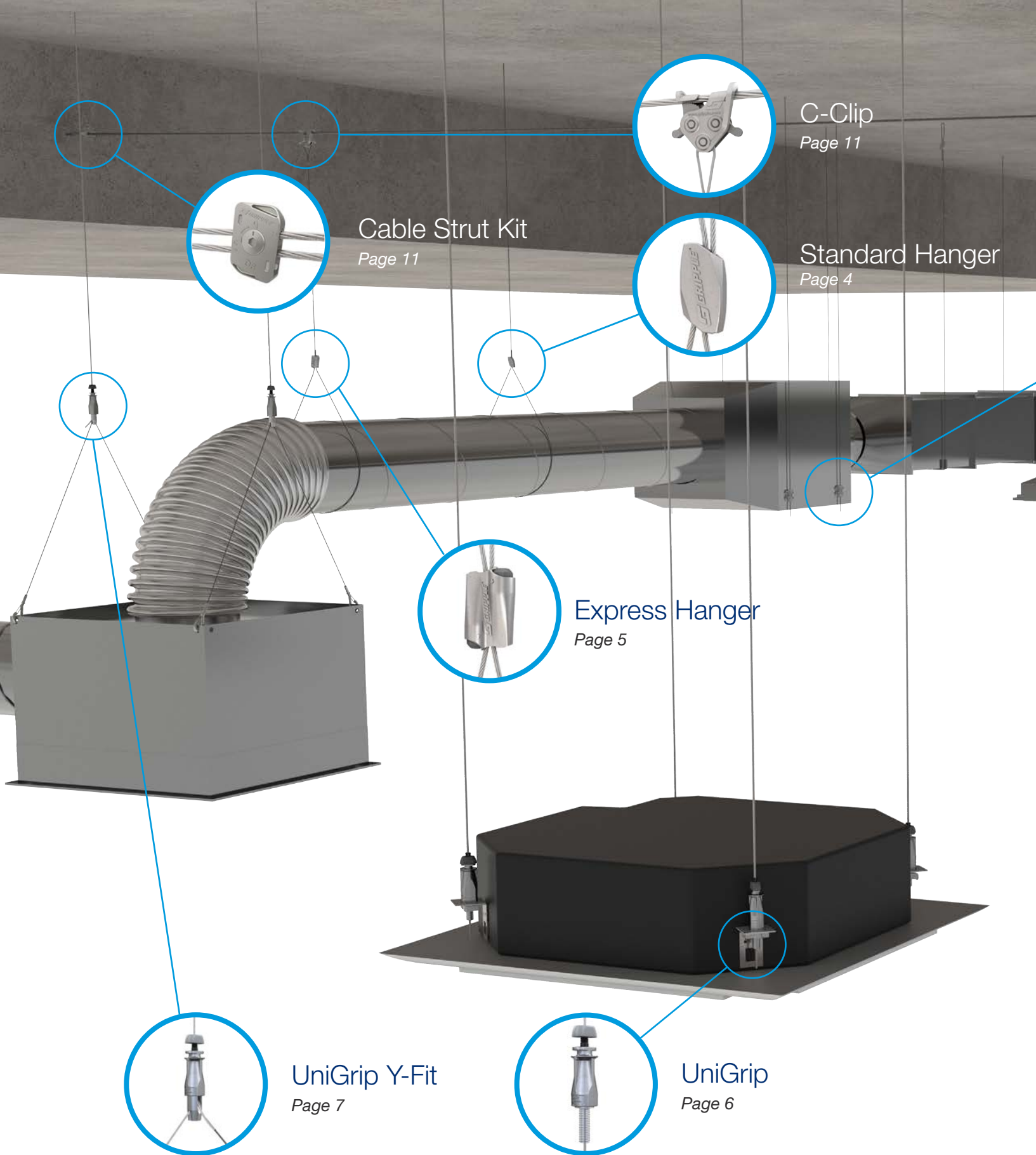

C-Clip
Page 11

Cable Strut Kit
Page 11

Standard Hanger
Page 4

Express Hanger
Page 5

UniGrip Y-Fit
Page 7

UniGrip
Page 6

Products shown only for internal use. Images shown for illustrative purposes only.
Please refer to product installation instructions for full information.



Butterfly Trapeze
Hanger

Page 9



Fast Trak

Page 12



Duct Trapeze
Hanger

Page 8



UniGrip
Calibra

Page 7

The Gripple® range of hangers for HVAC applications has been developed to provide a fast and versatile solution for suspending ductwork, heaters, air conditioning, radiant panels, and plenum boxes.

Our products are manufactured in the UK and USA, and are designed to save you time and labor costs, thus improving the efficiency of your installation. Unlike traditional suspension methods, Gripple kits do not require cutting or filing. Gripple suspension solutions offer aesthetic design without compromising on strength, and are supplied in ready-to-use kits with a choice of cable length and end fixing.

Standard Hanger

Cable hanger kit containing the original Gripple HangFast fastener, for suspending a variety of HVAC, piping, lighting, and electrical services.

- The only Gripple Hanger available in sizes No.1 thru No.5, with Safe Working Loads from 25 thru 715 lbs per hanger
- Ideal for fast suspension of any suspended service
- Up to 6 times faster to install than traditional methods
- Versatile and simple to use
- Strong, safe, and industry approved
- Aesthetically discreet and lightweight
- Fastener can be released with a Release Key to adjust or level the height of the service



Available in sizes No.1 - No.5



Supplied as ready-to-use kits with a length of cable, Standard fastener, and end fixing of your choice.

| 5:1 SAFETY FACTOR | No.1 | No.2 | No.3 | No.4 | No.5 |
|------------------------|--------|---------|---------|---------|---------|
| LOAD RATING PER HANGER | 25 lbs | 100 lbs | 200 lbs | 495 lbs | 715 lbs |

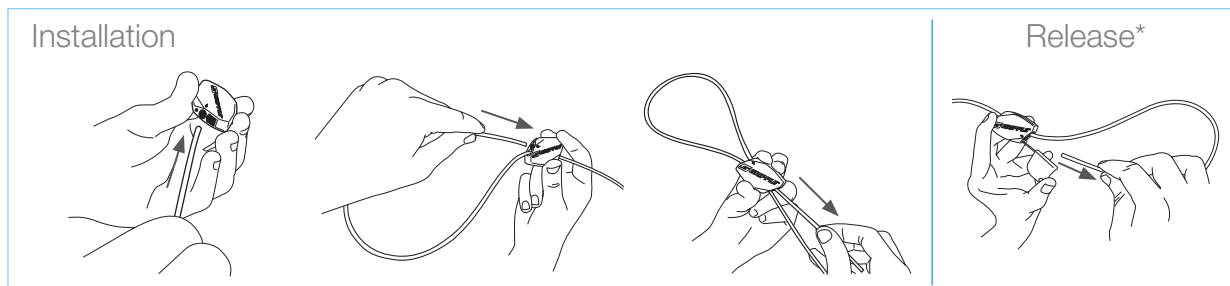

* When releasing: 1. Remove load, 2. Insert release key into hole, 3. Pull tail wire out

Express Hanger

For the fast suspension of a variety of services, designed with an easy push-button release mechanism.

- The Express No.1 is ideal for signage, shopfitting, lighting, and other lightweight fixtures
- The Express No.2 is ideal for mechanical and electrical services
- Up to 6 times faster to install than traditional methods
- Discreet and aesthetic design
- Ergonomic push buttons are easy to use
- No release key required to adjust or level the service



Available in sizes No.1 - No.2

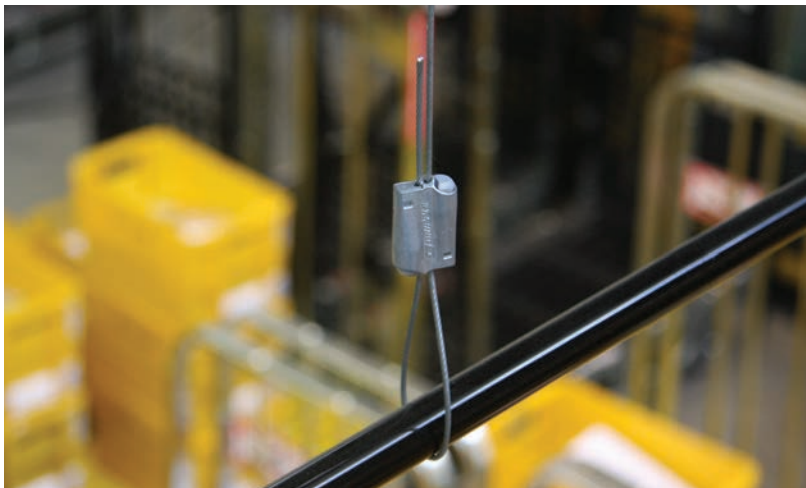

Supplied as ready-to-use kits with a length of cable, Express fastener, and end fixing of your choice.

| 5:1 SAFETY FACTOR | No.1 | No.2 |
|------------------------|--------|---------|
| LOAD RATING PER HANGER | 33 lbs | 100 lbs |

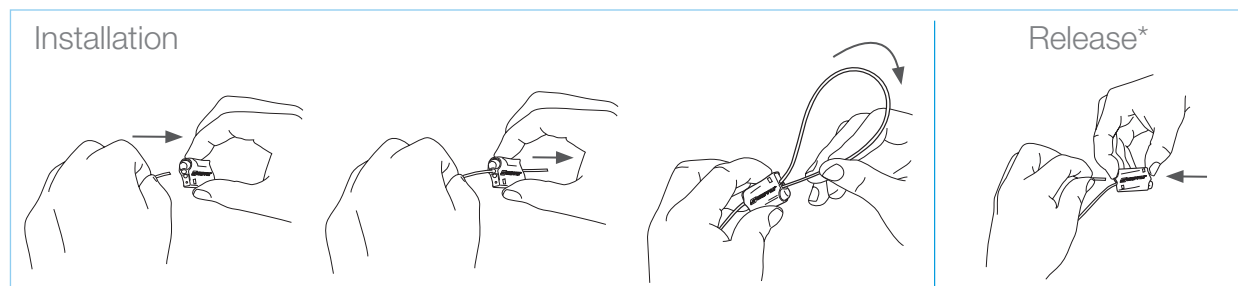

* When releasing: 1. Remove load, 2. Push release buttons, 3. Pull tail wire out

UniGrip Hanger

Designed for fast suspension of cable containment, piping, ductwork, HVAC systems and modules.

- Enhanced load performance
- Three times lighter than the Trapeze Plus product it succeeds
- Larger button delivers easier, one handed adjustment
- Locking indicator now offers visible certainty
- Ideal for creating multi-tiered installations
- Ideal for use with Gripple Pipe Bracket and QT Universal Clamp for piping suspensions



Available in sizes No. 2 - 4



Supplied as ready-to-use kits with a length of cable, UniGrip Hanger, and end fixing of your choice.

| 5:1 SAFETY FACTOR LOAD RATING* | No. 2 | No. 3 | No. 4 |
|-----------------------------------|---------|---------|---------|
| | 120 lbs | 240 lbs | 550 lbs |

* When UniGrip is utilized in conjunction with the Hook or 90° Eyelet end fixings the Safety Factor becomes 4:1.

Installation

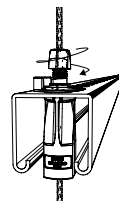
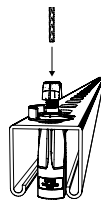
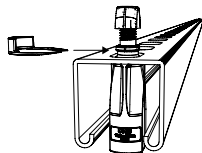
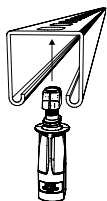

UniGrip Foot Variants

The range of UniGrip 'feet' ensures the product suits all possible building service applications.

CENTRAL EXIT

- **Ideal for:** Suspending piping, rectangular ductwork, air conditioning units, electrical containment, heating and ventilation units, chilled beams, busbar, modules, or clevis hangers in conjunction with a square washer and channel nut or a hex nut.



QT

- **Ideal for:** Securing into slots of Gripple Pipe Brackets to suspend piping, electrical containment, ductwork and other mechanical services when used with Gripple Pipe Brackets.



SIDE EXIT

- **Ideal for:** Suspended ceilings, heavy duty lighting, busbar, plenum boxes, single pipe runs, clevis hangers, or applications where exiting centrally clashes with services.



HOOK

- **Ideal for:** Fast attachment to heating and ventilation units, heavy duty signage, cable basket/tray, radiant panels, chilled beams.

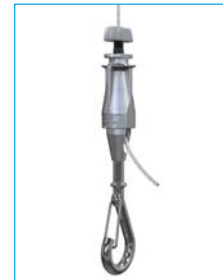

CABLE BASKET ADAPTER

- **Ideal for:** suspending cable basket runs in single or multi-tier installations.



CALIBRA

- **Ideal for:** Suspending radiant panels, chilled beams, heating, ventilation, and cooling units and provides the ability for finite height adjustments of services without removing the load.



Y-FIT

- **Ideal for:** Suspending cable containment, signage, heating and cooling units, heavy duty lighting, radiant panels, chilled beams, balanced pipework, plenum boxes.



PHENOLIC ADAPTER

- **Ideal for:** Phenolic & PIR fabricated ductwork.



| | Standard | Central Exit | Side Exit | QT | Calibra | Snap Hook | Y-Fit | Cable Basket Adapter | Phenolic Adapter |
|---------------|----------|--------------|-----------|----|---------|-----------|-------|----------------------|------------------|
| UniGrip No. 2 | | | | | | | | | |
| UniGrip No. 3 | | | | | | | | | |
| UniGrip No. 4 | | | | | | | | | |

 Available
  Unavailable

Supplied as ready-to-use kits with a length of cable, UniGrip Hanger, and end fixing of your choice.

Duct Trapeze Hanger

Ideal for fast suspension of rectangular ducting or similar services.

- Eliminates the need for a strut support
- Suitable for ducting made from 0.6 - 1.5 mm gauge steel
- Spreads the load across three fixing points
- Attaches with self-drilling screws or pop rivets (not provided)
- Optional rubber pad prevents air leakage and dampens vibration
- Release pin allows rapid height adjustment



Available in size No. 2
Rubber Pad is Sold Separately



Supplied as ready-to-use kits with a length of cable, Duct Trapeze fastener and end fixing of your choice.

| | |
|----------------------------------|---------|
| 5:1 SAFETY FACTOR LOAD RATING | No. 2 |
| | 100 lbs |

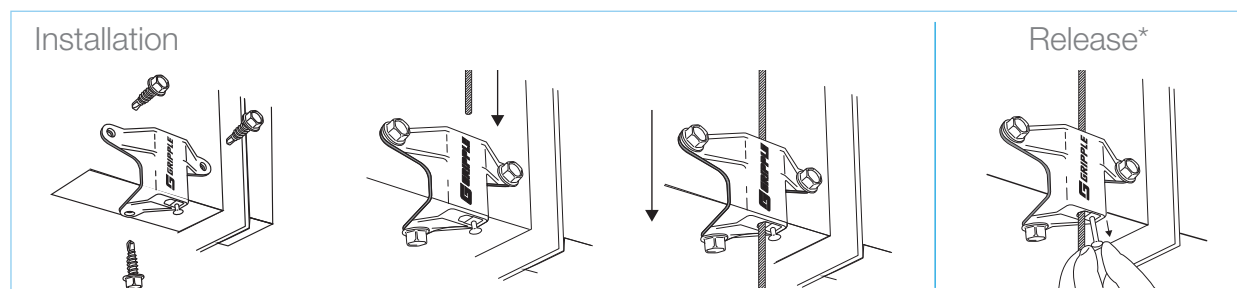

*When releasing: 1. Remove load, 2. Pull pin, 3. Raise or lower on cable

Butterfly Trapeze Hanger

Ideal for fast suspension of rectangular ducting or similar services that are hung close to the ceiling.

- Simple height adjustment using the integral pin prior to applying load
- Spreads the load across four fixing points
- Rubber pad prevents air leakage and dampens vibration
- Can be used for multi-tiered installations



Available in size No. 2



Supplied as ready-to-use kits with a length of cable, Butterfly Trapeze fastener, and end fixing of your choice.

| | |
|----------------------------------|---------|
| 5:1 SAFETY FACTOR LOAD RATING | No. 2 |
| | 100 lbs |

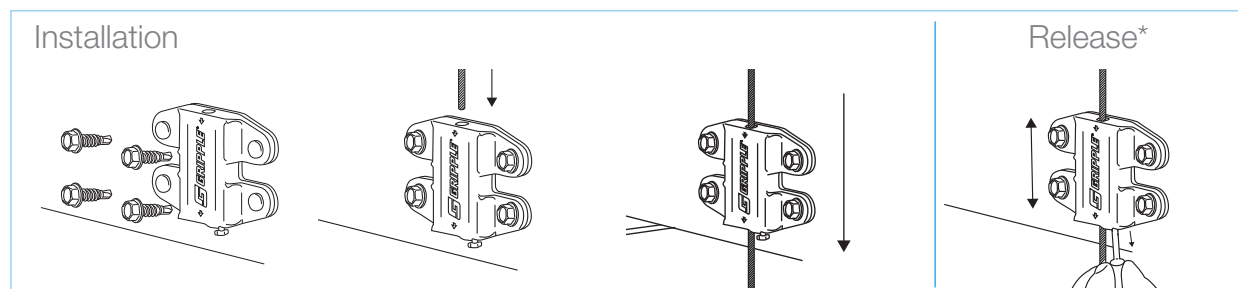

*When releasing: 1. Remove load, 2. Pull pin, 3. Raise or lower on cable

Stainless Steel Hanger

Used to suspend a variety of mechanical and electrical services in the food industry and high humidity environments.

- Stainless steel body and springs are corrosion resistant and long-lasting
- Ceramic rollers for extra strength and corrosion resistance
- Aesthetically discreet and lightweight
- Available in two sizes load rated up to 200 lbs SWL
- Available for use with Loop, 1/4" Stud, Hook, Y-Hook, Toggle, and Y-Toggle end fixings
- Fastener can be released with a Release Key to adjust or level the height of the service
- Like all Gripple hangers, not suitable for use in chlorinated or swimming pool environments



Available in sizes No. 2 - No. 3

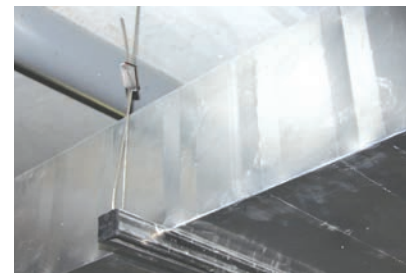

Supplied as ready-to-use kits with a length of cable, stainless steel fastener and end fixing of your choice.

| 5:1 SAFETY FACTOR LOAD RATING | No. 2 | No. 3 |
|----------------------------------|---------|---------|
| | 100 lbs | 200 lbs |

Installation

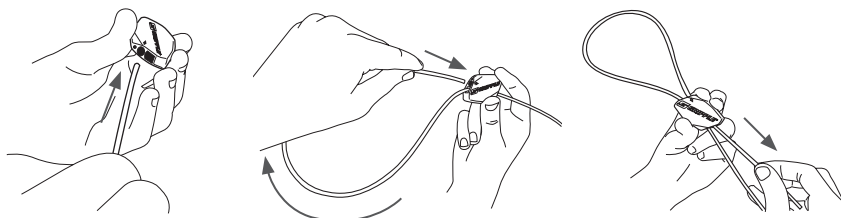

Release

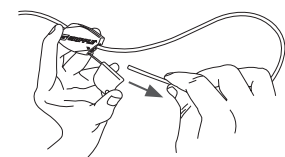

* When releasing: 1. Remove load, 2. Release key into hole, 3. Pull tail wire out.

Cable Strut Kit & C-Clip Hanger

Create secure, overhead spans by running high strength cable between two fixed points. Ideal for applications where no direct vertical anchor point is available. The Gripple C-Clip, an innovative twist-on/off device, allows you to suspend from anywhere along the horizontal span.

- Visually discreet and lightweight
- Allows for suspension of services exactly where needed
- No tools needed to install
- Available in 1/8" and 1/4" cable diameters, for suspensions up to 220 lbs per span
- C-Clip End Fixing allows for horizontal and vertical adjustment
- C-Clip Cams lock solidly in place, even at angles up to 60°



Available in 1/8" and 1/4" systems

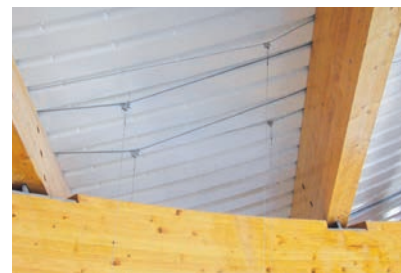
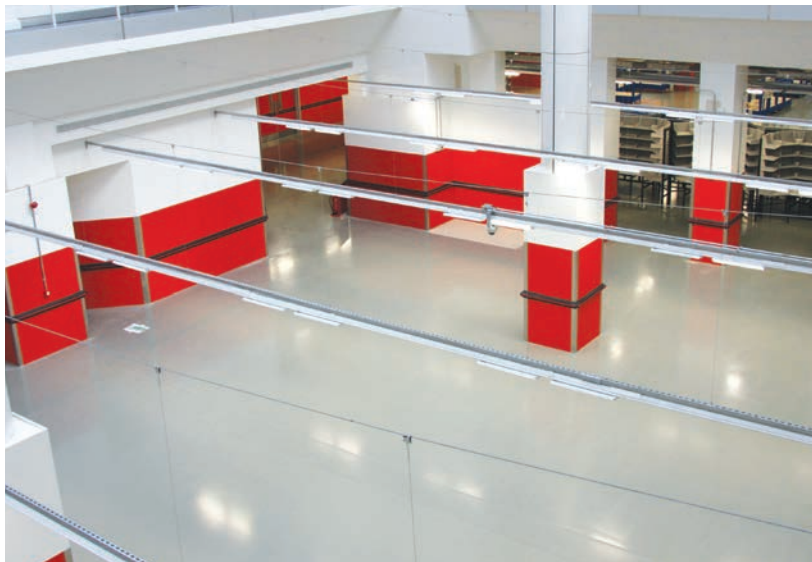

Cable Strut supplied as ready-to-use kits, including galvanized cable cut to length, two fasteners, and a Release Key. (C-Clip Hangers sold separately)

| 5:1 SAFETY FACTOR LOAD RATING CABLE SPAN | 1/8" | 1/4" |
|---|--------|---------|
| | 66 lbs | 220 lbs |

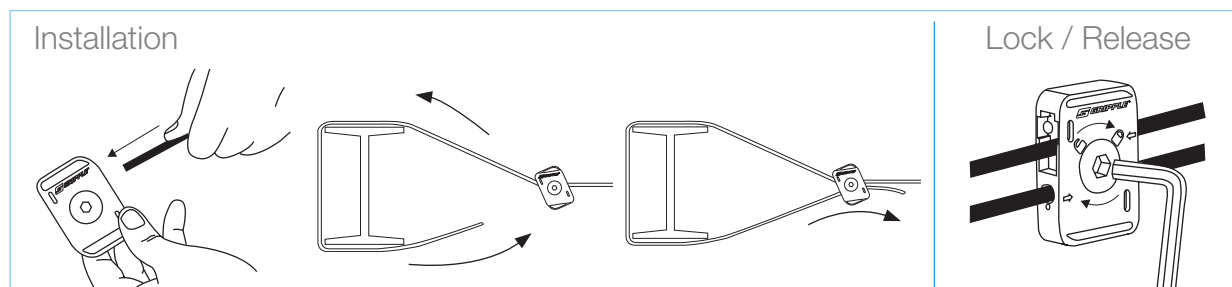

Fast Trak

Pre-fabricated rigid support solution offering speed, flexibility, and efficient use of space, for the installation of electrical containment, ductwork and other mechanical services.

- **Safe:** A pre-fabricated system which removes the need to cut threaded rod or channel on site
- **Strong:** 400 lbs SWL with a 3:1 safety factor per system
- **Quick:** Up to six times faster to install than traditional suspension systems
- **Adjustable:** Bracket can be moved up and down the track without tools
- **Secure:** Safety lock ensures security once bracket is in place
- **Compatible:** Two-point ceiling fixing using shot fire, drop in anchor or wedge
- **Zero Waste:** Excess tracks bend neatly under bracket
- **Space Saver:** System can be 'stacked' on-site within a small area



Available in nine bracket widths and three drop lengths



3:1 SAFETY FACTOR
LOAD RATING

Per Bracket

400 lbs

Installation

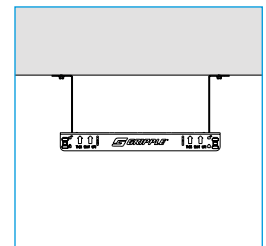
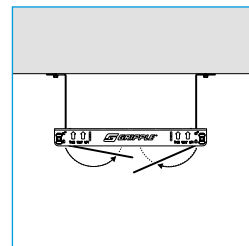
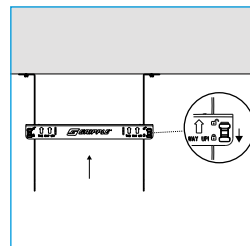
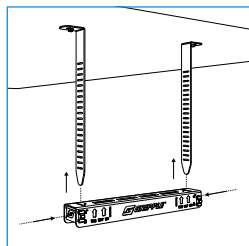
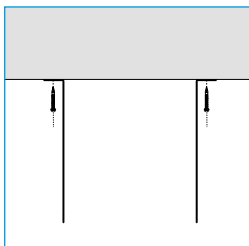

Accessories

Individual fasteners are available separately as an accessory to allow multi-tiered installations from one suspension cable.



Butterfly Trapeze

Ideal for use with light ductwork. Combine Butterfly Trapeze as an accessory with any Trapeze kit for multi-tiered installations. Maximum load rating of 100 lbs with a 5:1 safety factor.

Product code: SBT2



Duct Trapeze

Ideal for use with rectangular ductwork. Combine Duct Trapeze as an accessory with any Trapeze kit for multi-tiered installations. Maximum load rating of 100 lbs with a 5:1 safety factor.

Product code: SDT2



Standard UniGrip

Ideal for Piping, rectangular ductwork, air conditioning units, electrical containment, heating and ventilation units, multi-tier applications.

Product code: UG2 and UG3



UniGrip QT

Ideal for Piping, electrical containment, ductwork and other mechanical services when used with Gripper Pipe Support Brackets.

Product code: UG2-QT and UG3-QT



UniGrip Central Exit

Ideal for Piping, rectangular ductwork, air conditioning units, electrical containment, heating and ventilation units, chilled beams, busbar, modules, and multi-tier applications.

Product code: UG2-SE-FN and UG3-SE-FN



Cable Basket Adapter

Ideal for cable basket, multi-tier applications.

Product code: UG2-FN-CB6 and UG3

A variety of additional accessories are available to complement the product range, increasing versatility and ease of installation.



Spider (Wood Form)

Universal, versatile, cast-in-place concrete insert for wood form construction, allowing for fast and easy suspension of all building services.

Product Code: SX-WF



Spider (Metal Deck)

Universal, versatile, cast-in-place concrete insert for metal deck construction, allowing for fast and easy suspension of all building services.

Product Code: SX-MD

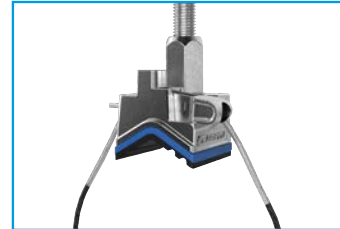

Universal Clamp

Ideal for the quick and easy support of spiral ductwork in conjunction with threaded rod.

Up to 6 times faster than traditional methods.

Product Code: GC2-3/8-24IN



Corner Saddle

Right-angled molding attaches to bottom corners of rectangular duct to protect against friction from the cable hanger. Available in standard and magnetic versions.

Product Code: CORNER-SADDLE



Trapeze Bracket

Combine with Trapeze No.2 and No.3 for easy attachment to rectangular ductwork or services. Maximum load rating of 100 lbs (No.2), 200 lbs (No.3) with a 5:1 safety factor.

Product Code: TPZ-BRACKET



Beam and Purlin Clips

Available in a variety of sizes and models for attachment to beams and purlins.

Product Codes: GCB24, GCB59, GCB1016, or GCB1720

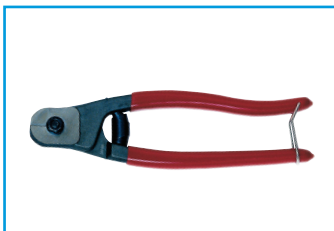

Cable Cutters

Purpose-made for use on up to 3/16" cable. For use when terminating cable lengths.

Product Code: CUTTER-GRIPPLE

www.gripple.com
grippleinc@gripple.com



Rist & Associates

4 Washington Ave
Des Moines, IA 50314
P: (515) 243-8720
F: (515) 243-8714
www.ristandassociates.com

Gripple Inc

1611 Emily Lane
Aurora
Illinois 60502
USA

T | +1 866 474 7753
F | +1 800 654 0689
E | grippleinc@gripple.com

Gripple Canada Inc

7015 Ordan Drive
Unit #15 Mississauga
Ontario L5T 1Y2
CAN

T | +1 905 458 8700
F | +1 800 654 0689
E | CAinfo@gripple.com

Gripple Ltd (Headquarters)

The Old West Gun Works
Savile Street East
Sheffield S4 7UQ
UK

T | +44 (0) 800 018 4264
F | +44 (0) 114 275 1155
E | info@gripple.com

Gripple Europe SARL

1, rue du commerce
BP 37
67211 Obernai Cedex
France

T | +33 (0)3 88 95 44 95
F | +33 (0)3 88 95 08 78
E | frinfo@gripple.com

Gripple India

B 95/2
Naraina Industrial Area
Phase I
New Delhi-110028

T | +91 11-40582703
F | +91 11-40582703
E | ininfo@gripple.com

BROC-HVAC-US

Published JAN 2021

Please refer to www.gripple.com for the most up to date user advice and product information.



WE ARE SOCIAL
FOLLOW OUR UPDATES



© 2021 Gripple

Gripple is a registered trademark of Gripple Limited.

Company registered in England No. 1772901, VAT Reg No. GB 600 1951 88